

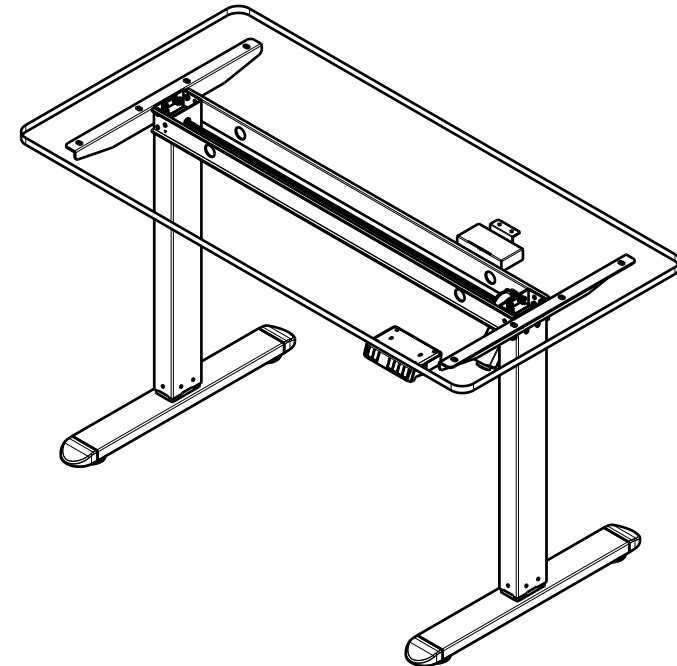

## ASSEMBLY INSTRUCTIONS

MODEL: AD-A4

PROGRAMMABLE SINGLE MOTOR STANDING DESK  
WITH TABLETOP



Please take the time to carefully read this manual before using the product.

If you need customer support, please call us at

**1-800-267-1783**

**[www.AnthroDesk.ca](http://www.AnthroDesk.ca) [Canada]**

**[www.AnthroDesk.com](http://www.AnthroDesk.com) [USA]**

Handset Interface

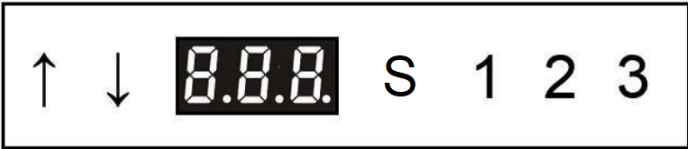

↑	UP	1	HEIGHT MEMORY BUTTON 1
↓	DOWN	2	HEIGHT MEMORY BUTTON 2
S	SETTING BUTTON	3	HEIGHT MEMORY BUTTON 3

Desk Initialization:

When the system is unresponsive, or the handset displays "RST," it is necessary to initialize the standing desk. The initialization operation involves pressing and holding <↓> until the frame has reached the lowest position. Next, press and hold <↓> for 5 seconds until you hear a beep.

Desk Operation:

Press <↑> to move the desk up until it reaches the highest position.  
Press <↓> to move the desk down until it reaches the lowest position.  
Pressing <↑> or <↓> shortly runs the desk a short distance.

Memory Function:

This handset can save pre-set heights.

Move the desk up or down to the desired position.

1. Press <S> briefly until the display shows “S-”, and “-” flashes, then press <1> to save position 1.
2. Repeat the procedure to save the other positions.

Height Settings:

The system supports the height limit of the desk. The operation method is to press and hold the <↑> and <↓> buttons simultaneously for 5 seconds at the desired height until you hear the buzzer, indicating that the limit position is successfully stored. When the desk is in the upper half of the stroke, the limit is the highest position. When it is in the lower half of the table stroke, the limit is the lowest position.

Disabling the Height Limit:

**Method 1:** Reset the system, and the high and low limits will be canceled.

**Method 2:** Run the desk to the high or low limit point, then press and hold the <↑> and <↓> buttons simultaneously for 5 seconds until you hear the buzzer, indicating that the limit position is successfully canceled.

Lock and Unlock:

**Lock:** Press and hold <S> and <↑> together for 5 seconds. When the digital display shows "Loc," it means the system has been locked, and the desk cannot be raised or lowered.

**Unlock:** Press and hold <S> and <↓> together for 5 seconds. When the digital display changes from "Loc" to the normal digits, it means the system has been unlocked.

Reset:

When the system's leg is replaced with a new one, or the parameters need to be restored to the factory settings, press and hold <↑> and <↓> simultaneously for 10 seconds to hear a long buzzer. The parameters will be restored to the factory settings and forced to initialize.

Timing Setting:

To set the timing, simultaneously press the <1> and <3> buttons until the handset displays x.xh. Then, use the <↑> or <↓> buttons to adjust the timing, with each press changing the timing by 0.5 hours. The settings will automatically exit after 2 seconds. At this point, a decimal point will flash on the handset, indicating that the timing is active. When the set timing is reached, the handset will beep 5 times and wake up automatically.

Internal Parameters and Installation Distance Setting:

To access the internal parameters and installation distance settings, long-press <S> for 15 seconds. The handset will display "S-x," with "x" flashing (where "x" represents the parameter group). Press <S> again to enter the parameter group and set the corresponding parameters, and use <↑> or <↓> to switch between parameter groups. Once the settings are adjusted successfully, press <S> to return to the running interface.

The parameters that can be set are as follows:

“S-1” CM or INCH:

Use <↑> or <↓> to select 1 for INCH or 0 for CM. To save the selection, press <S> again.

“S-6” determine automatic or manual operation of memory buttons.

0: Manual. Press and hold any of the memory buttons until the preset height is reached.

1: Automatic. Press any of the memory buttons to automatically move to the preset height.

Error Code

Error Code	Description	Action
E01	The main supply voltage is over 45V.	Check the main power supply.
E02	The rod height difference between the two legs is more than 1 cm.	Initialize the frame and reset the operation.
E04	Handset connection or communication error occurred.	Check the power cable of the handset.
E05	The sensor encounters an obstacle and stops functioning.	Release the button and restart the system.
E06	The main power supply failed to start, below 20V.	Change the main power supply or check the power supply cable.
E07	Protection triggered when the main power supply is running below 20V.	Reconnect the power and perform a power-on reset.
E08	The frame tilts when running.	Initialize the frame and reset the operation.
HOT	1. The temperature of the motor is high.	1. Wait for the motor to cool down.

	2. The running time exceeds 2 mins within 18 mins.	2. Let the system rest for at least 18 mins.
E11	The Motor 1 is not connected.	Check the power cable of the motor.
E12	Error in the Motor 1 current sampling channel.	Change the control box.
E13	The Motor 1 is out of phase and has a phase line disconnection.	Check the motor to determine whether the phase line connection is abnormal.
E14	The Motor 1 Hall sensor error, or Hall wire disconnected.	Check the Hall signal, or change the power cable of the motor.
E15	Short-Circuit inside the Motor 1.	Change the motor.
E16	Locked-Rotor inside the Motor 1.	Initialize the frame and reset the operation.
E17	The Motor 1 runs in the wrong direction.	Change the motor wire or Hall wire.
E18	Weight on Motor 1 is over the limit.	Reduce the weight by removing items.
E21	The Motor 2 is not connected.	Check the power cable of the motor.
E22	Error in the Motor 2 current sampling channel.	Change the control box.
E23	The Motor 2 is out of phase and has a phase line disconnection.	Check the motor to determine whether the phase line connection is abnormal.
E24	The Motor 2 Hall sensor error, or Hall wire disconnected.	Check the Hall signal, or change the power cable of the motor.
E25	Short-Circuit inside the Motor 2.	Change the motor.
E26	Locked-Rotor inside the Motor 2.	Initialize the frame and reset the operation.
E27	The Motor 2 runs in the wrong direction.	Change the motor wire or Hall wire.
E28	Weight on Motor 2 is over the limit.	Reduce the weight by removing items.
E40	The control box is disconnected in series.	Check the connection wires.
E41	Error in the serial signal.	Check the connection wires or change the control box.
E42	EEPROM error.	Change the control box.
E43	Error in the Anti-Collision Sensor.	Change the control box.

Parts and Tool List

NO	NAME	QTY	NO	NAME	QTY
1	Lifting System	1 set	11	M6*35 Screw	8
2	Feet	2	12	Plastic Pad	2
3	Sidebars	2	13	Rubber Cushion	8
4	Support Beam	2	14	ST3.5*19 Screw	2
5	Hex Rod	1	15	ST4.8*10 Screw	2
6	Adaptor Holder	1	16	ST4.8*16 Screw	8
7	2.5mm allen key	1			
8	4mm allen key	1			
9	M4*35 Screw	2			
10	M6*10 Screw	16			

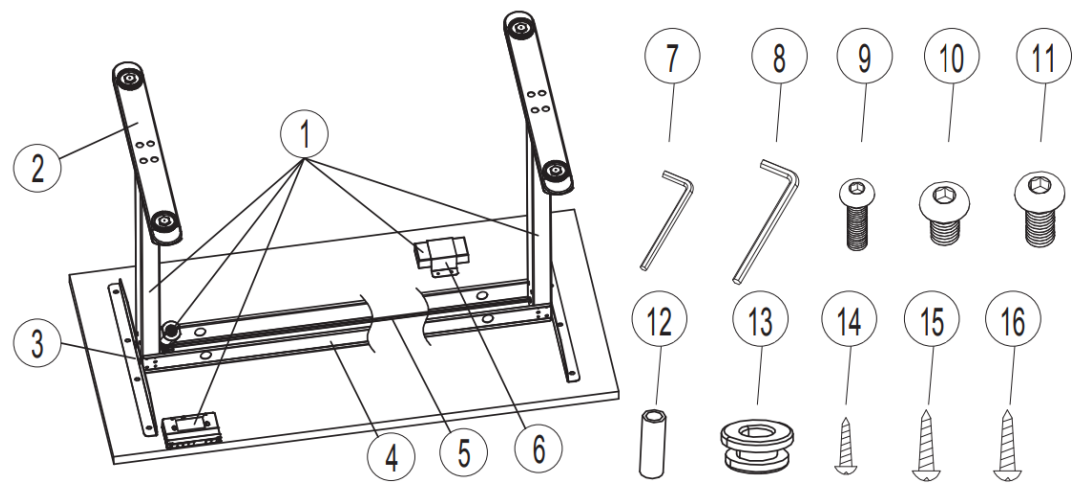

Begin by mounting the motor onto the hex rod. Next, insert the assembled hex rod into one of the legs and secure the motor in place using two M4\*35 screws. Then, attach the other end of the hex rod to the remaining leg. Lastly, affix the beam to the legs using a total of 12 M6\*10 screws.

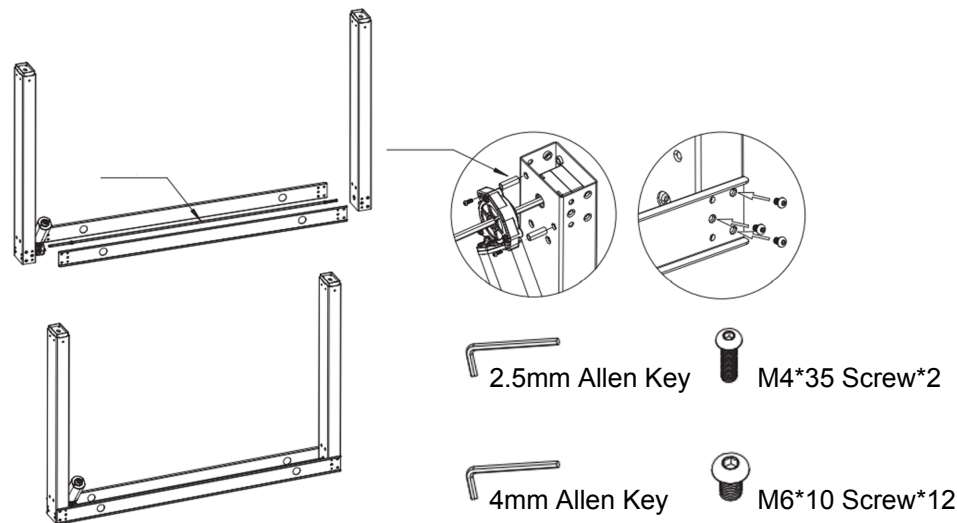

Attach feet to the legs using 8 of M6\*35 screws.

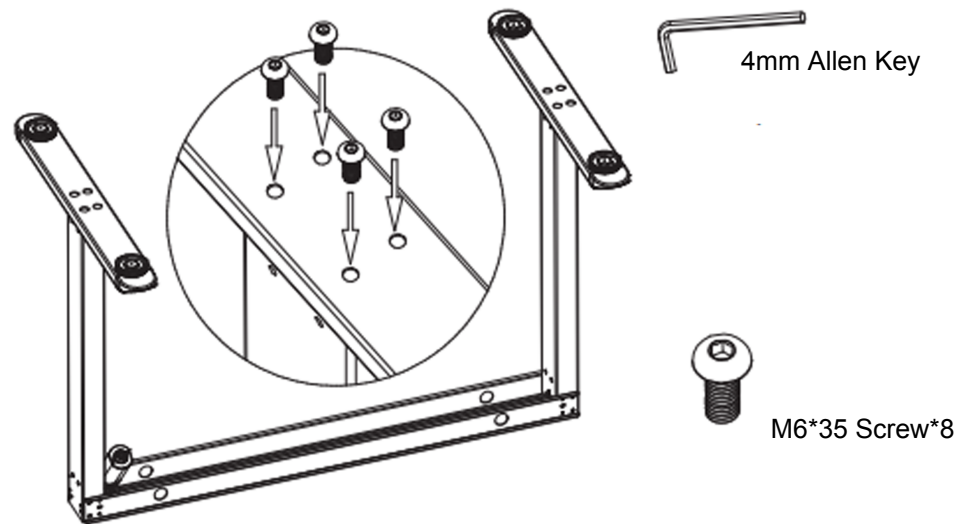

Attach sidebar to legs using 4 of M6\*10 screws fit the 8 rubber cushions to the sidebar.

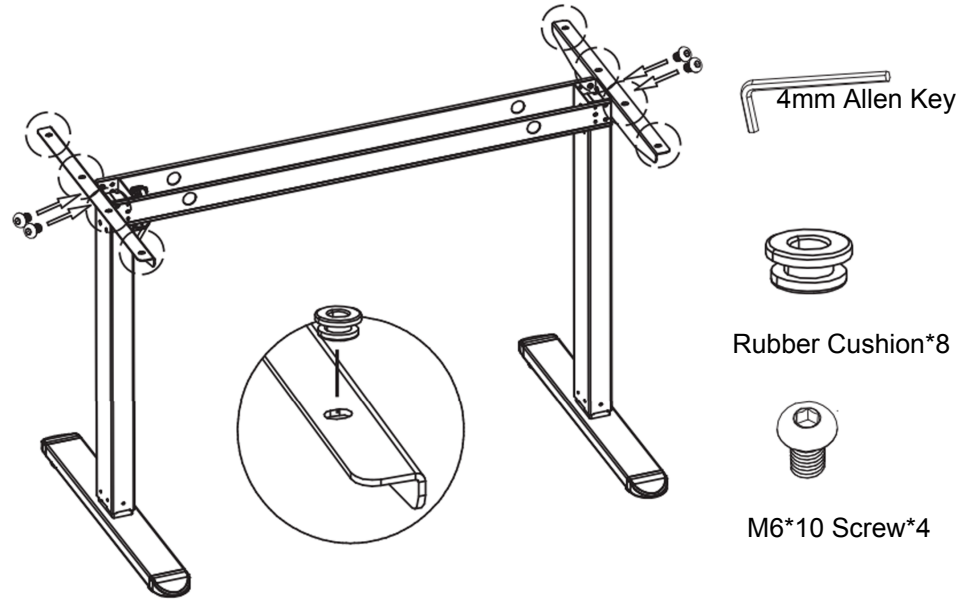

Secure the frame to the table top using 8 ST4.816 screws. Next, attach the adaptor holder below the table top with 2 ST4.810 screws. Finally, fasten the handset to the underside of the table top using 2 ST3.5\*19 screws.

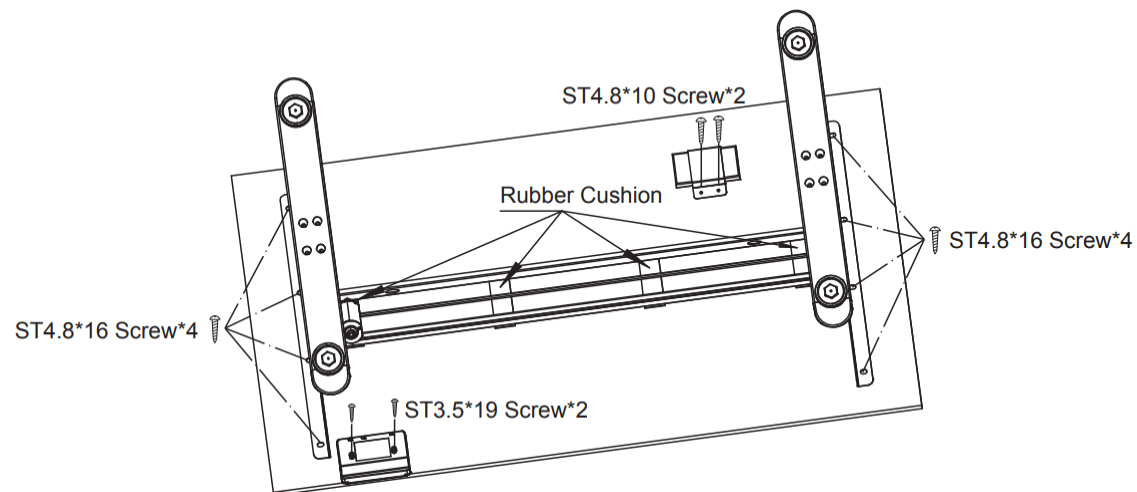

Connect the motor and the adaptor to the handset, connect the power cord to the adaptor.

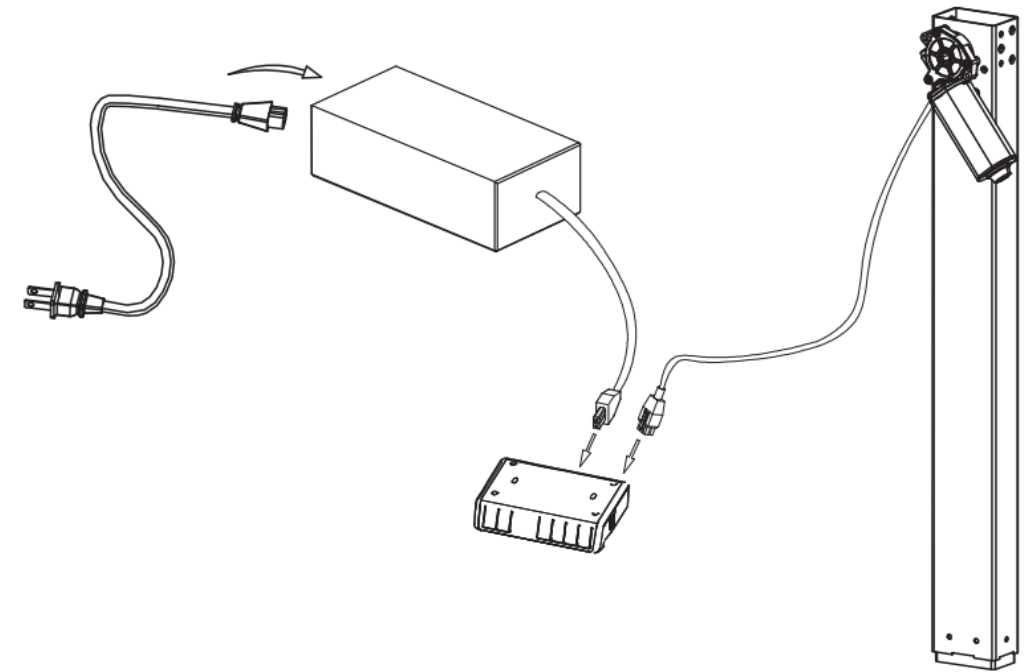

## Product Specifications

**Number of Presets:** 3

**Frame Width Adjustable:** No

**Frame Width:** 103.5 cm (40.75 inches)

**Frame Height Adjustable:** 70-118 cm (27.56-46.46 inches)

**Weight Capacity:** 90 kg (198.42 pounds) (<60kg recommended for normal use)

**Load Speed:** 1 cm/s (0.39 inches/s)

**Table Top Depth:** 60 cm (23.62 inches)

**Table Top Width:** 120 cm (47.24 inches)

**Foot:** 60 cm (23.62 inches)

**Bracket:** 50 cm (19.69 inches)

**Noise:** ≤50 db